

Phone: 218-739-4641  
Fax: 218-739-4008  
www.shoremaster.com

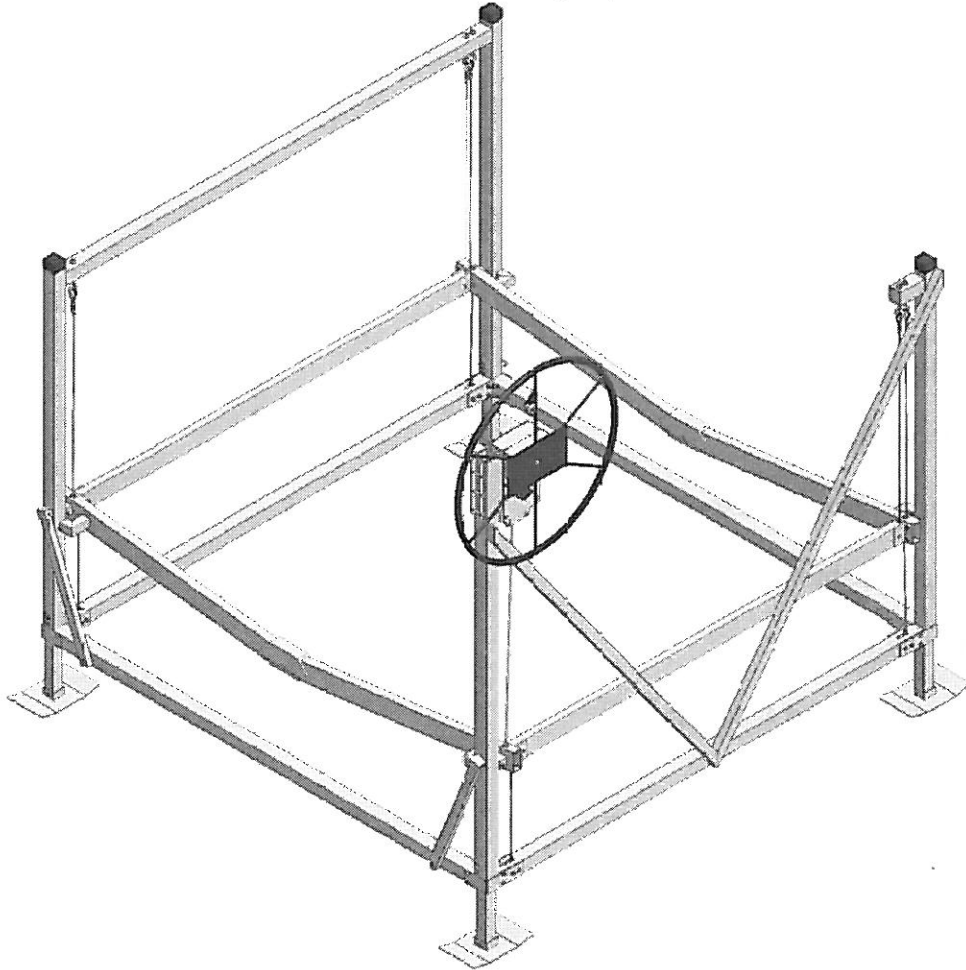

3000# - 4000#

Vertical Lift: Instructions and Safety Tips



## CAUTION – PUT SAFETY FIRST

1. Before attempting to install or operate this hoist, study and fully understand the proper operating procedures and safety precautions outlined in this owner's manual.
2. Never exceed the recommended weight capacity of your lift. The lifted weight will include hull, engine, fuel, battery, and added accessories or gear. Weigh your fully loaded boat at a certified scale to be absolutely sure of the total weight.
3. Do not allow anyone on, in or under the lift while operating.
4. NOT COMPLYING WITH THE PROCEDURES AND PRECAUTIONS OUTLINED IN THIS MANUAL WILL INVALIDATE THE WARRANTY AND MAY RESULT IN PERSONAL INJURY OR DEATH.
5. If you have any questions about assembly, installation, operation or suitability of this product, contact an authorized dealer or ShoreMaster directly at 1-800-328-8945.

# TABLE OF CONTENTS

Exploded Views	3-9
Accessories	10
Parts	11
Fasteners and Hardware	12-13
Assembly	14-20
Cable Locations	21
Winch / Wheel Assembly	22-24
Proper Cable Adjustment	25
Installation	26
Operation and Maintenance	27-28
Limited Warranty	29
Warranty Card	30

# 30966 VERTICAL LIFT (V-RACK)

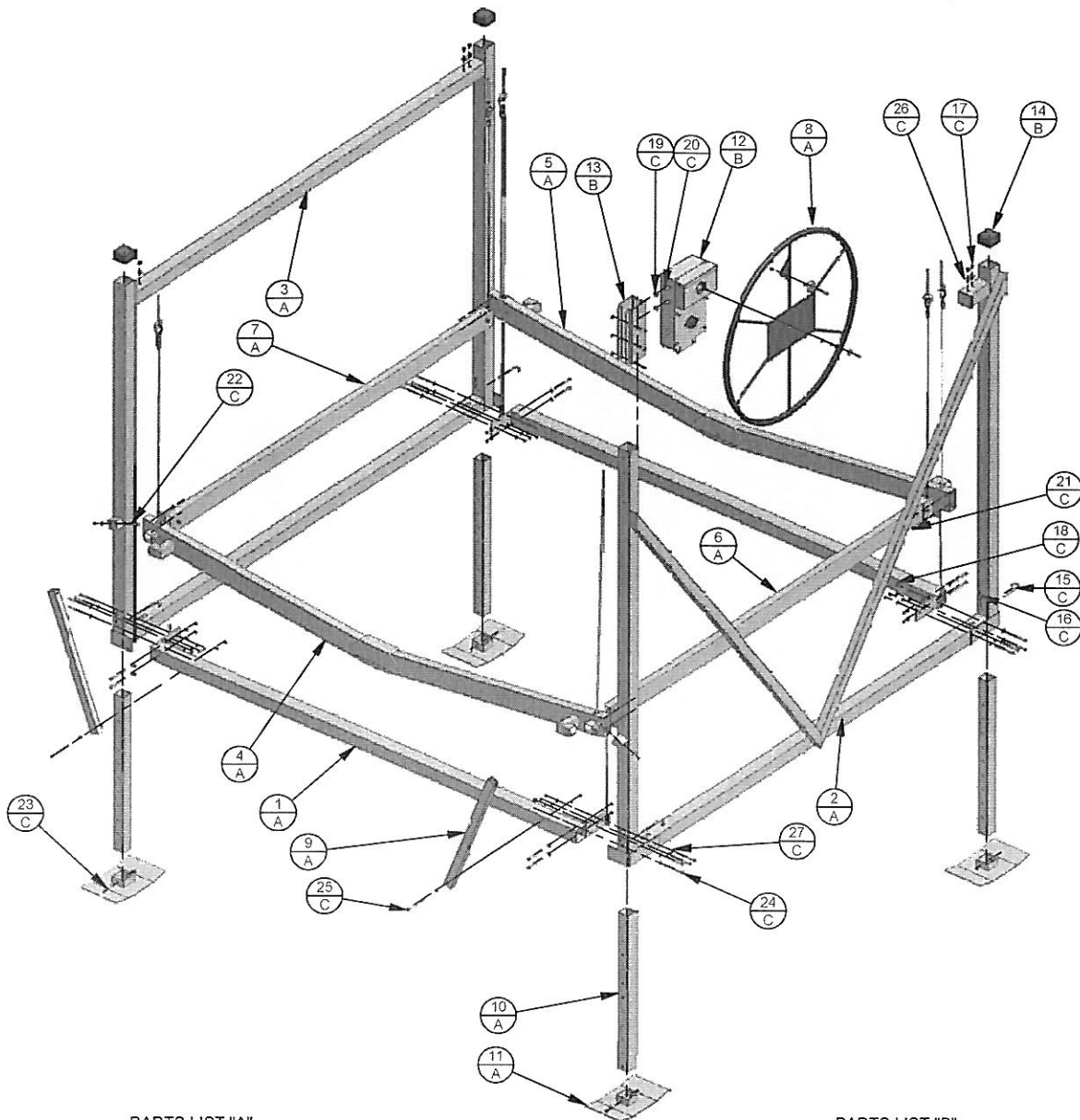

## PARTS LIST "A"

\*BDL30966L - BUNDLE 30966 LIFT\*

ITEM	QTY	PART NUMBER	DESCRIPTION
1	2	LP30966BB	BOTTOM BEAM
2	1	LP30866VS	LIFT V SIDE
3	1	LP30866OS	OPPOSITE LIFT SIDE
4	1	LP3096FRB	FRONT RACK
5	1	LP3096RRB	REAR RACK
6	1	LP2838LRS	LEFT RACK SIDE
7	1	LP2838RRS	RIGHT RACK SIDE
8	1	LP00WHEEL	LARGE WHEEL
9	2	76903075D	VERTICAL LIFT BRACE
10	4	31303800D	LEG POST
11	4	LPC-3LPAD	FOOT PAD

## \*\*REPLACEMENT CABLES\*\*

FRONT CABLE: PART# - S516235CC  
 REAR CABLE: PART # - S1401881C  
 SIDE CABLE: PART # - S141765CC

## PARTS LIST "B"

\*LWB030966 - WINCH/HARDWARE BOX 3/4000# VERTICAL\*

ITEM	QTY	PART NUMBER	DESCRIPTION
12	1	LP3000VWM	ALUMINUM WINCH
13	1	APWMNTCLP	WINCH MOUNT
14	3	BLUECAP11	BLUE CAP 3 X 3 X 2

## PARTS LIST "C"

\*LBB030966 - BOLT BAG COMPLETE 3/4000# VERTICAL

ITEM	QTY	PART NUMBER	DESCRIPTION
15	4	S3832932P	PIN 3/8 X 3 29/32
16	4	LSPINCLIP	HAIR PIN KEEPER
17	5	B12 LOCNUT	NUT 1/2 NYLOC BRASS
18	43	B380RGNUT	NUT 3/8 BRASS
19	2	S380SQNUT	NUT SQUARE 1/2
20	2	MM1201145	BOLT 1/2 X 1 1/4
21	8	MS380114B	BOLT 3/8 X 1 1/4
22	5	MS380234B	BOLT 3/8 X 2 3/4
23	4	MS380312B	BOLT 3/8 X 3 1/2
24	24	MS380414B	BOLT 3/8 X 4 1/4
25	2	MS380334B	BOLT 3/8 X 3 3/4
26	7	S120WASHR	WASHER FLAT 1/2
27	72	S380WASHR	WASHER FLAT 3/8

# 30966 VERTICAL LIFT (STRAIGHT RACK)

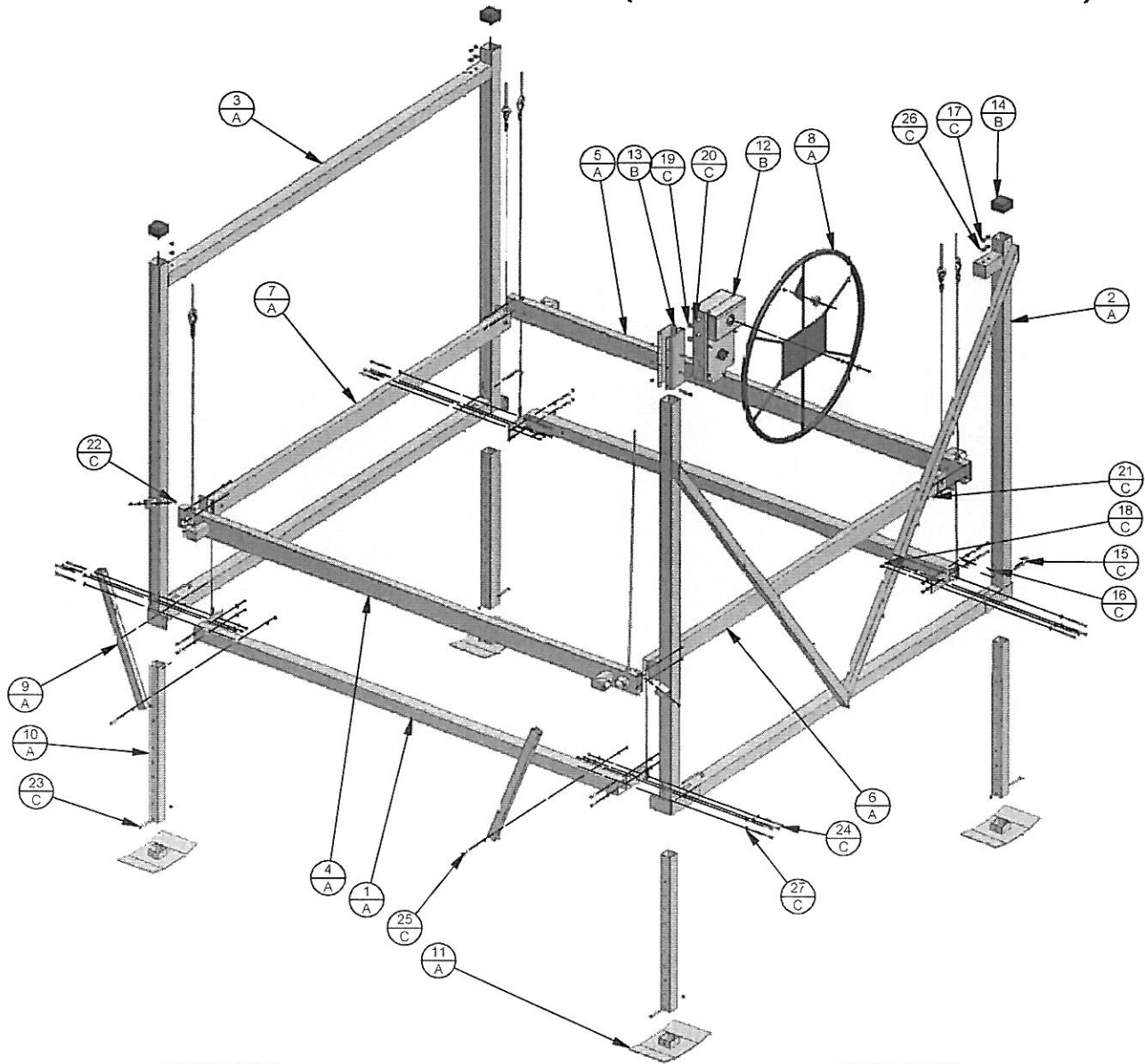

PARTS LIST "A"

*BLP30966L - BUNDLE 30966 LIFT (STRAIGHT RACK)*			
ITEM	QTY	PART NUMBER	DESCRIPTION
1	2	LP30966BB	BOTTOM BEAM
2	1	LP30866VS	LIFT V SIDE
3	1	LP30866OS	OPPOSITE LIFT SIDE
4	1	LPPL30FRB	FRONT RACK
5	1	LPPL30RRB	REAR RACK
6	1	LP2838LRS	LEFT RACK SIDE
7	1	LP2838RRS	RIGHT RACK SIDE
8	1	LP00WHEEL	LARGE WHEEL
9	2	76903075D	VERTICAL LIFT BRACE
10	4	31303600D	LEG POST
11	4	LPC-3LPAD	FOOT PAD

PARTS LIST "B"

*LWB030966 - WINCH/HARDWARE BOX 3/4000# VERTICAL*			
ITEM	QTY	PART NUMBER	DESCRIPTION
12	1	LP3000VWM	ALUMINUM WINCH
13	1	APWMNTCLP	WINCH MOUNT
14	3	BLUECAP11	BLUE CAP 3 X 3 X 2

PARTS LIST "C"

*LBB030966 - BOLT BAG COMPLETE 3/4000# VERTICAL*			
ITEM	QTY	PART NUMBER	DESCRIPTION
15	4	S3832932P	PIN 3/8 X 3 29/32
16	4	LSPINCLIP	HAIR PIN KEEPER
17	5	B12 LOCNUT	NUT 1/2 NYLOC BRASS
18	43	B380RGNUT	NUT 3/8 BRASS
19	2	S380SQNUT	NUT SQUARE 1/2
20	2	MM1201145	BOLT 1/2 X 1 1/4
21	8	MS380114B	BOLT 3/8 X 1 1/4
22	5	MS380234B	BOLT 3/8 X 2 3/4
23	4	MS380312B	BOLT 3/8 X 3 1/2
24	24	MS380414B	BOLT 3/8 X 4 1/4
25	2	MS380334B	BOLT 3/8 X 3 3/4
26	7	S120WASHR	WASHER FLAT 1/2
27	72	S380WASHR	WASHER FLAT 3/8

**\*\*REPLACEMENT CABLES\*\***

FRONT CABLE: PART# - S516235CC  
 REAR CABLE: PART # - S141955CC  
 SIDE CABLE: PART # - S141765CC

# 301066 VERTICAL LIFT (STRAIGHT RACK)

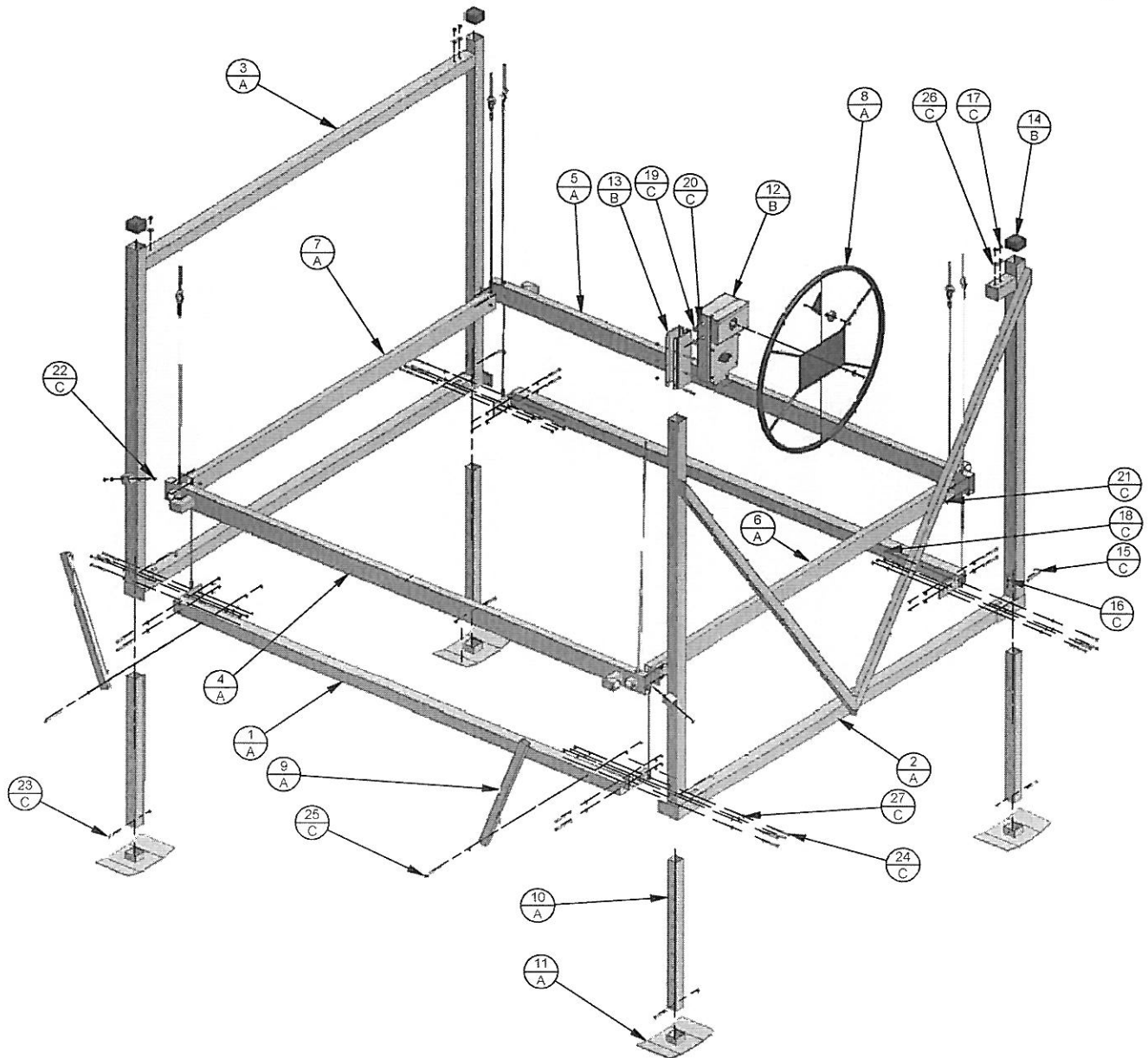

PARTS LIST "A"

*BDL301066 - BUNDLE 301066 LIFT (STRAIGHT-RACK)*			
ITEM	QTY	PART NUMBER	DESCRIPTION
1	2	LP31066BB	BOTTOM BEAM
2	1	LP30866VS	LIFT V SIDE
3	1	LP30866OS	OPPOSITE LIFT SIDE
4	1	LP3106FRB	FRONT RACK
5	1	LP3106RRB	REAR RACK
6	1	LP2838LRS	LEFT RACK SIDE
7	1	LP2838RRS	RIGHT RACK SIDE
8	1	LP00WHEEL	LARGE WHEEL
9	2	76903075D	VERTICAL LIFT BRACE
10	4	31303600D	LEG POST
11	4	LPC-3LPAD	FOOT PAD

**\*\*REPLACEMENT CABLES\*\***

FRONT CABLE: PART# - S516245CC  
 REAR CABLE: PART # - 110001830  
 SIDE CABLE: PART # - S141765CC

PARTS LIST "B"

*LWB030966 - WINCH/HARDWARE BOX 3/4000# VERTICAL*			
ITEM	QTY	PART NUMBER	DESCRIPTION
12	1	LP3000VWM	ALUMINIUM WINCH
13	1	APWMNTCLP	WINCH MOUNT
14	3	BLUECAP11	BLUE CAP 3 X 3 X 2

PARTS LIST "C"

*LBB030966 - BOLT BAG COMPLETE 3/4000# VERTICAL*			
ITEM	QTY	PART NUMBER	DESCRIPTION
15	4	S3832932P	PIN 3/8 X 3 29/32
16	4	LSPINCLIP	HAIR PIN KEEPER
17	5	B12 LOCNUT	NUT 1/2 NYLOC BRASS
18	43	B380RGNUT	NUT 3/8 BRASS
19	2	S380SQNUT	NUT SQUARE 1/2
20	2	MM1201145	BOLT 1/2 X 1 1/4
21	8	MS380114B	BOLT 3/8 X 1 1/4
22	5	MS380234B	BOLT 3/8 X 2 3/4
23	4	MS380312B	BOLT 3/8 X 3 1/2
24	24	MS380414B	BOLT 3/8 X 4 1/4
25	2	MS380334B	BOLT 3/8 X 3 3/4
26	7	S120WASHR	WASHER FLAT 1/2
27	72	S380WASHR	WASHER FLAT 3/8

# 40966 VERTICAL LIFT (V-RACK)

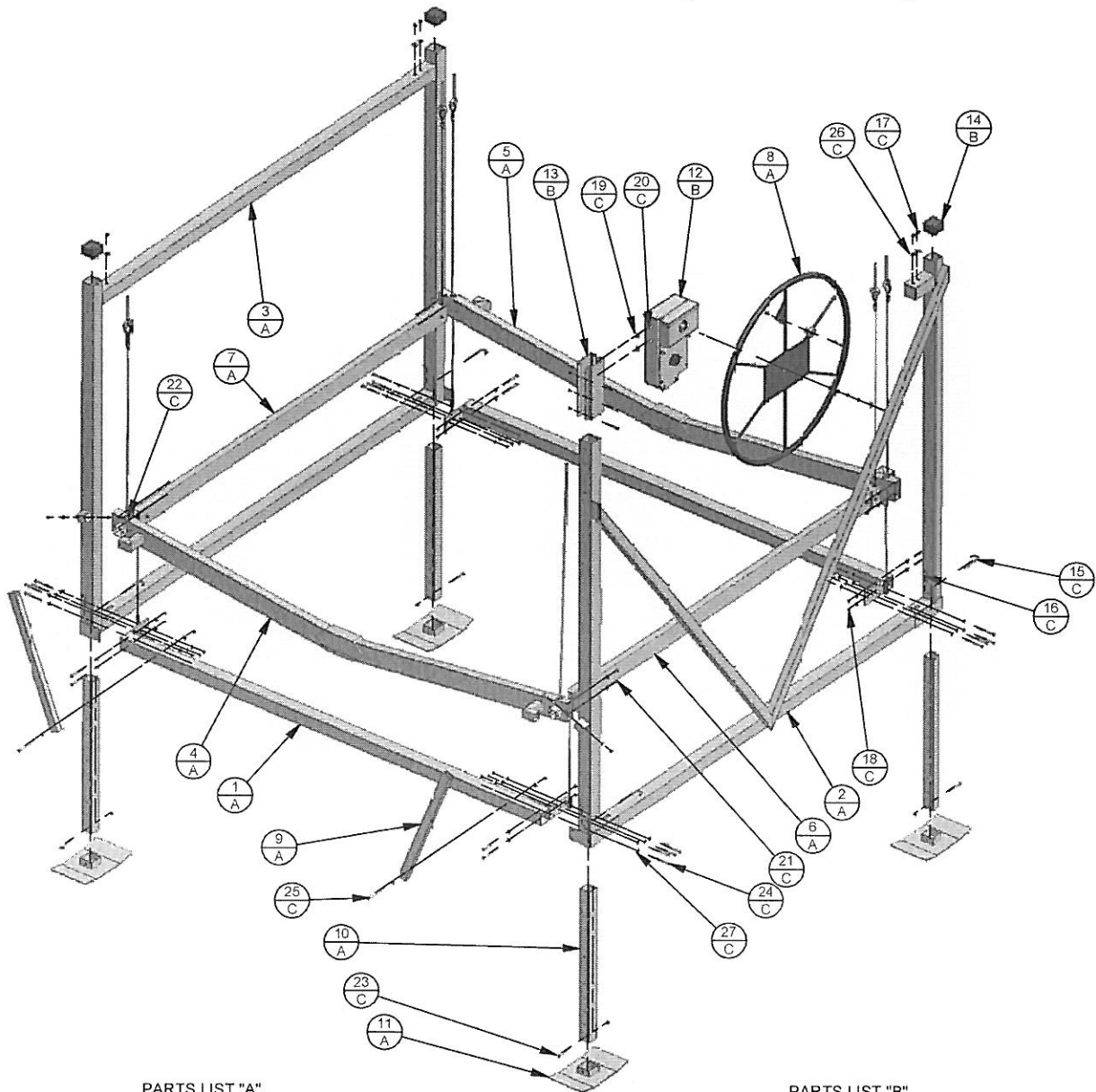

PARTS LIST "A"

*BDL40966L - BUNDLE 40966 LIFT (V-RACK)*			
ITEM	QTY	PART NUMBER	DESCRIPTION
1	2	LP40966BB	BOTTOM BEAM
2	1	LP38966VS	LIFT V SIDE
3	1	LP38966OS	OPPOSITE LIFT SIDE
4	1	LP4096FRB	FRONT RACK
5	1	LP4096RRB	REAR RACK
6	1	LP2838LRS	LEFT RACK SIDE
7	1	LP2838RRS	RIGHT RACK SIDE
8	1	LP00WHEEL	LARGE WHEEL
9	2	76903075D	VERTICAL LIFT BRACE
10	4	31303500D	LEG POST
11	4	LPC-3LPAD	FOOT PAD

PARTS LIST "B"

*LWB030966 - WINCH/HARDWARE BOX 3/4000# VERTICAL*			
ITEM	QTY	PART NUMBER	DESCRIPTION
12	1	LP3000VWM	ALUMINUM WINCH
13	1	APWMNTCLP	WINCH MOUNT
14	3	BLUECAP11	BLUE CAP 3 X 3 X 2

PARTS LIST "C"

*LBB030966 - BOLT BAG COMPLETE 3/4000# VERTICAL*			
ITEM	QTY	PART NUMBER	DESCRIPTION
15	4	S3832932P	PIN 3/8 X 3 29/32
16	4	LSPINCLIP	HAIR PIN KEEPER
17	5	B12 LOCNUT	NUT 1/2 NYLOC BRASS
18	43	B380RGNUT	NUT 3/8 BRASS
19	2	S380SQNUT	NUT SQUARE 1/2
20	2	MM1201145	BOLT 1/2 X 1 1/4
21	8	MS380114B	BOLT 3/8 X 1 1/4
22	5	MS380234B	BOLT 3/8 X 2 3/4
23	4	MS380312B	BOLT 3/8 X 3 1/2
24	24	MS380414B	BOLT 3/8 X 4 1/4
25	2	MS380334B	BOLT 3/8 X 3 3/4
26	7	S120WASHR	WASHER FLAT 1/2
27	72	S380WASHR	WASHER FLAT 3/8

**\*\*REPLACEMENT CABLES\*\***

FRONT CABLE: PART# - S516235CC  
 REAR CABLE: PART # - S1401881C  
 SIDE CABLE: PART # - S141765CC

# 40966 VERTICAL LIFT (STRAIGHT RACK)

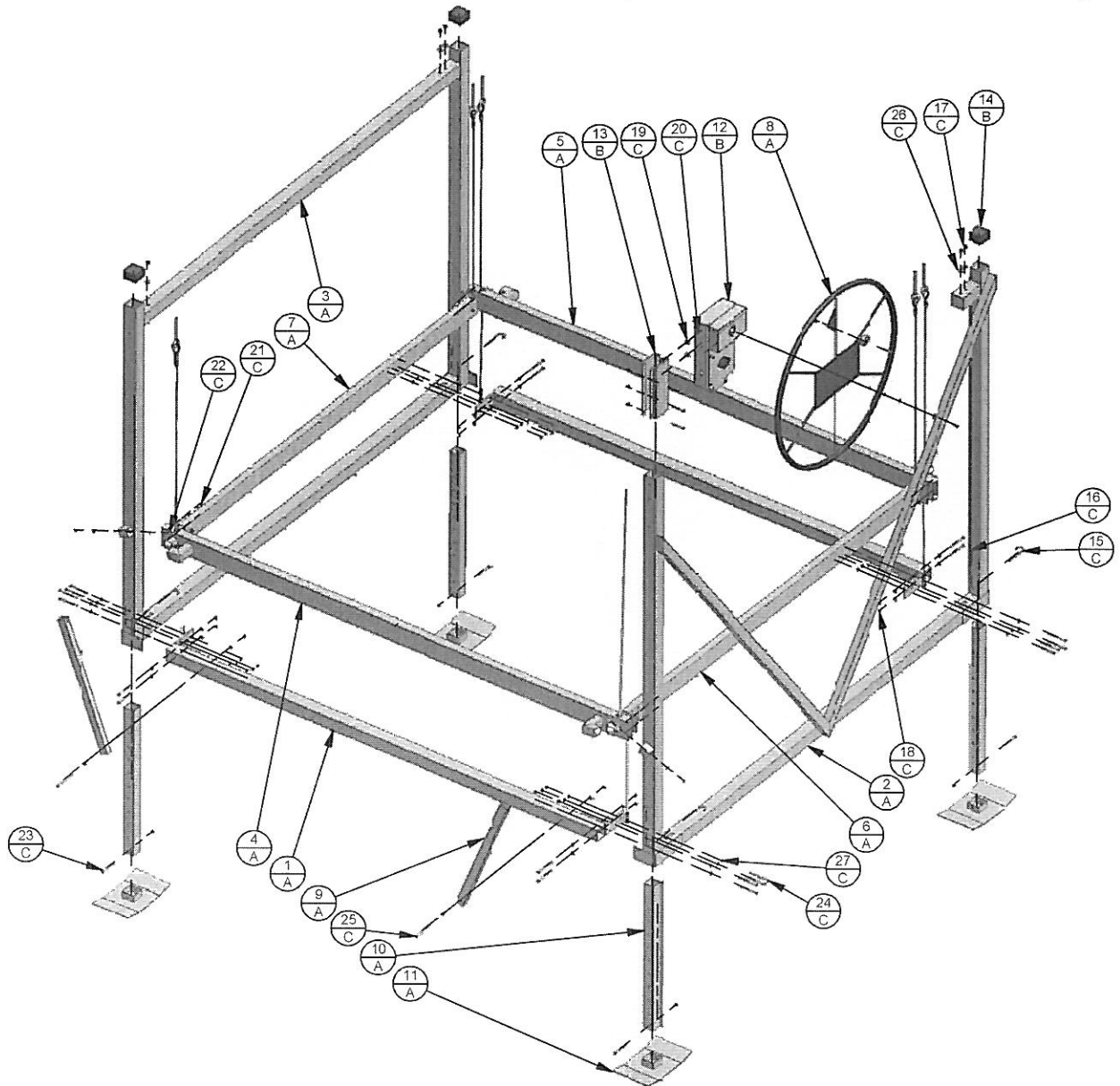

PARTS LIST "A"

*BLP40966L - BUNDLE 40966 LIFT (STRAIGHT-RACK)*			
ITEM	QTY	PART NUMBER	DESCRIPTION
1	2	LP40966BB	BOTTOM BEAM
2	1	LP38966VS	LIFT V SIDE
3	1	LP38966OS	OPPOSITE LIFT SIDE
4	1	LP3618PFB	FRONT RACK
5	1	LP3618PRB	REAR RACK
6	1	LP2838LRS	LEFT RACK SIDE
7	1	LP2838RRS	RIGHT RACK SIDE
8	1	LP00WHEEL	LARGE WHEEL
9	2	76903075D	VERTICAL LIFT BRACE
10	4	31303600D	LEG POST
11	4	LPC-3LPAD	FOOT PAD

**\*\*REPLACEMENT CABLES\*\***

FRONT CABLE: PART# - S516235CC  
 REAR CABLE: PART # - S141955CC  
 SIDE CABLE: PART # - S141765CC

PARTS LIST "B"

*LWB030966 - WINCH/HARDWARE BOX 3/4000# VERTICAL*			
ITEM	QTY	PART NUMBER	DESCRIPTION
12	1	LP3000VWM	ALUMINUM WINCH
13	1	APWMTCLP	WINCH MOUNT
14	3	BLUECAP11	BLUE CAP 3 X 3 X 2

PARTS LIST "C"

*LBB030966 - BOLT BAG COMPLETE 3/4000# VERTICAL*			
ITEM	QTY	PART NUMBER	DESCRIPTION
15	4	S3832932P	PIN 3/8 X 3 29/32
16	4	LSPINCLIP	HAIR PIN KEEPER
17	5	B12 LOCNUT	NUT 1/2 NYLOC BRASS
18	43	B380RGNUT	NUT 3/8 BRASS
19	2	S380SQNUT	NUT SQUARE 1/2
20	2	MM1201145	BOLT 1/2 X 1 1/4
21	8	MS380114B	BOLT 3/8 X 1 1/4
22	5	MS380234B	BOLT 3/8 X 2 3/4
23	4	MS380312B	BOLT 3/8 X 3 1/2
24	24	MS380414B	BOLT 3/8 X 4 1/4
25	2	MS380334B	BOLT 3/8 X 3 3/4
26	7	S120WASHR	WASHER FLAT 1/2
27	72	S380WASHR	WASHER FLAT 3/8

# 401066 VERTICAL LIFT (V-RACK)

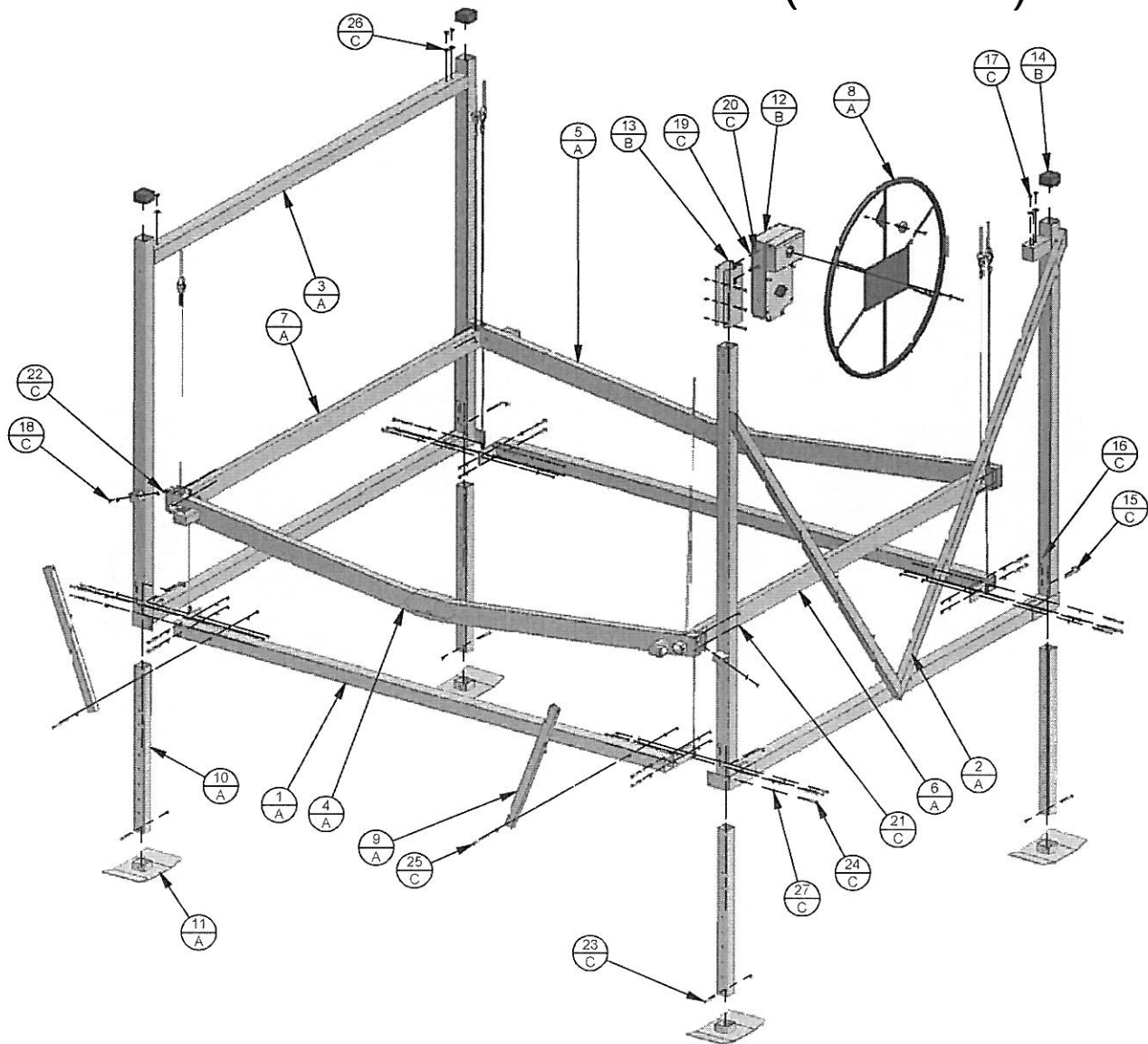

PARTS LIST "A"

*BDL401066 - BUNDLE 401066 LIFT (V-RACK)*			
ITEM	QTY	PART NUMBER	DESCRIPTION
1	2	LP41066BB	BOTTOM BEAM
2	1	LP38966VS	LIFT V SIDE
3	1	LP38966OS	OPPOSITE LIFT SIDE
4	1	LP4106FRB	FRONT RACK
5	1	LP4106RRB	REAR RACK
6	1	LP2838LRS	LEFT RACK SIDE
7	1	LP2838RRS	RIGHT RACK SIDE
8	1	LP00WHEEL	LARGE WHEEL
9	2	76903075D	VERTICAL LIFT BRACE
10	4	31303600D	LEG POST
11	4	LPC-3LPAD	FOOT PAD

**\*\*REPLACEMENT CABLES\*\***

FRONT CABLE: PART# - S516245CC  
 REAR CABLE: PART # - S140201CC  
 SIDE CABLE: PART # - S141765CC

PARTS LIST "B"

*LWB030966 - WINCH/HARDWARE BOX 3/4000# VERTICAL*			
ITEM	QTY	PART NUMBER	DESCRIPTION
12	1	LP3000VWM	ALUMINUM WINCH
13	1	APWMNTCLP	WINCH MOUNT
14	3	BLUECAP11	BLUE CAP 3 X 3 X 2

PARTS LIST "C"

*LBB030966 - BOLT BAG COMPLETE 3/4000# VERTICAL*			
ITEM	QTY	PART NUMBER	DESCRIPTION
15	4	S3832932P	PIN 3/8 X 3 29/32
16	4	LSPINCLIP	HAIR PIN KEEPER
17	5	B12 LOCNUT	NUT 1/2 NYLOC BRASS
18	43	B380RGNUT	NUT 3/8 BRASS
19	2	S380SQNUT	NUT SQUARE 1/2
20	2	MM1201145	BOLT 1/2 X 1 1/4
21	8	MS380114B	BOLT 3/8 X 1 1/4
22	5	MS380234B	BOLT 3/8 X 2 3/4
23	4	MS380312B	BOLT 3/8 X 3 1/2
24	24	MS380414B	BOLT 3/8 X 4 1/4
25	2	MS380334B	BOLT 3/8 X 3 3/4
26	7	S120WASHR	WASHER FLAT 1/2
27	72	S380WASHR	WASHER FLAT 3/8



# ALUMINUM WINCH

WINCH MODEL NUMBERS:  
 VERTICAL - LP3000VWM  
 CANTILEVER - LP3000CWM

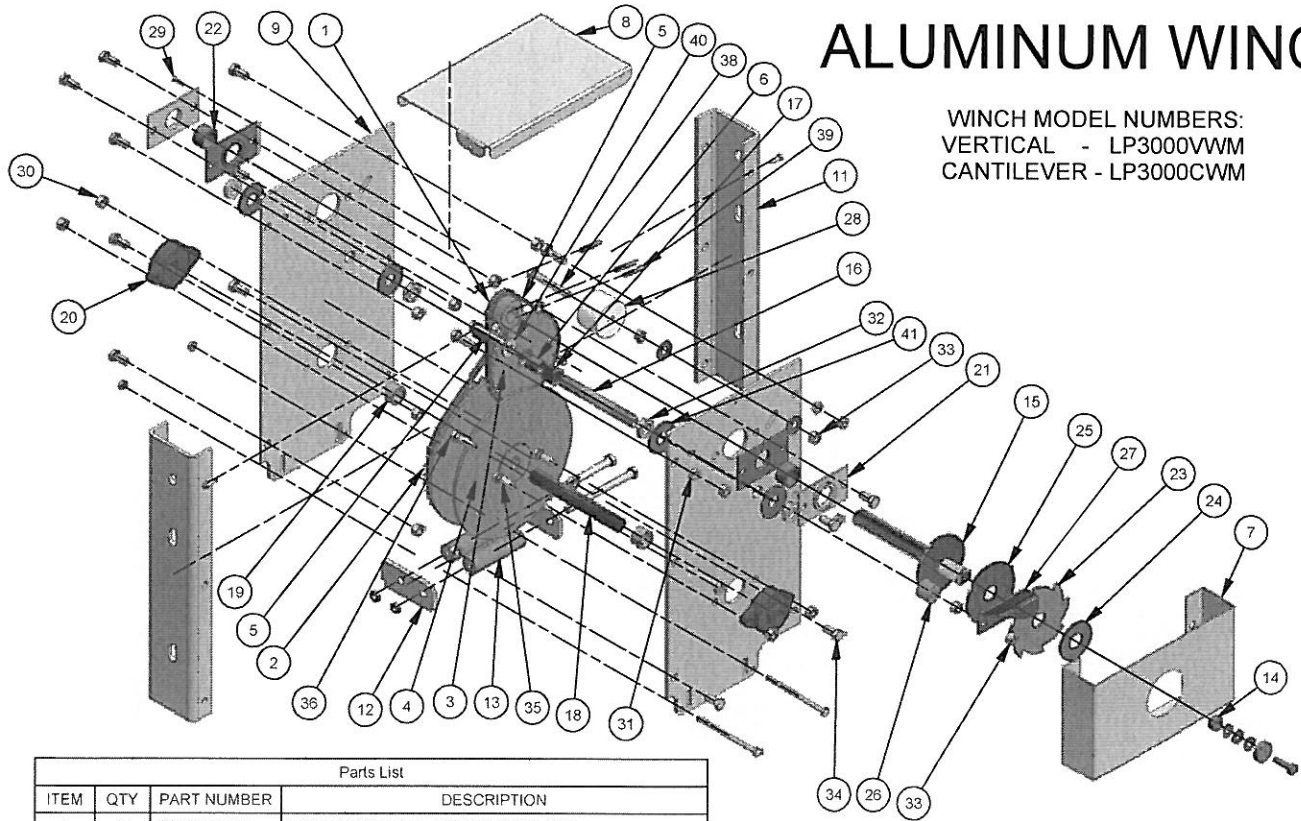

Parts List			
ITEM	QTY	PART NUMBER	DESCRIPTION
1	1	G&GSM1024	DRIVE SPROCKET 40B12 ALUM WINCH
2	1	G&GSM1038	CHAIN LOWER #40-54 W/MASTER LINK ALUM WINCH
3	1	APALW3ISA	IDLER SPROCKET ASSEMBLY ALUM WINCH
4	1	G&GSM1020	CABLE HUB ASSEMBLY ALUM WINCH
5	1	G&GSM1037	CHAIN LOWER #40-38 W/MASTER LINK ALUM WINCH
6	2	APALW3BSH	BUSHING OILITE (B-1012-6)
7	1	APALW3SRD	SHROUD ALUM WINCH
8	1	APALW3COV	TOP COVER ALUM WINCH
9	2	APALW3PLT	PLATE ALUM WINCH
11	1	APALW3RTP	RIGHT SIDE ALUM WINCH
12	2	APALW3RPL	ROLLER PLATE ALUM WINCH
13	1	MGCBLGRBB	BOLT BAG CABLE GUIDE ROLLER ALUM WINCH
14	1	SMWHEEKIT	WHEEL KIT ALUM WINCH
15	1	APALW3USA	UPPER SHAFT ASSEMBLY ALUM WINCH
16	1	APALW3CSH	CENTER SHAFT ALUM WINCH
17	1	APALW3CSP	CENTER SPACER ALUM WINCH
18	1	APALW3LWS	LOWER SHAFT ALUM WINCH
19	2	APALW3LSP	LOWER SPACER ALUM WINCH
20	2	SM0711501	CAST FLANGE BEARING SBLF 204 12 N ALUM WINCH
21	4	WP0710073	FLANGETTE ALUM WINCH
22	2	WP0710074	BUSHING NYLON 7/8 ID X 5/8
23	1	G&GSM1006	RATCHET GEAR ALUM WINCH
24	1	*SEE NOTE*	*SEE NOTE @ RIGHT*
25	1	SM0700041	BRAKE PAD LARGE 3 5/16 OD ALUM WINCH
26	1	APALW3BSP	BRAKE SPACER ALUM WINCH
27	1	APALW3RPW	RATCHET PAWL ALUM WINCH
28	1	UHMWCT138	CHAIN TIGHTENER UHMW ALUM WINCH
29	3	S1024012B	SCREW SELF-TAP 10 - 32 X 5/8
30	19	B380RGNUT	NUT 3/8 BRASS
31	4	M38JAMNUT	NUT JAM 3/8
32	4	B58JAMNUT	NUT JAM 5/8 BRASS
33	3	M380CLNUT	NUT CENTER LOCK 3/8 ZINC
34	12	MS380034B	BOLT 3/8 X 3/4
35	4	MS380100B	BOLT 3/8 X 1
36	4	MS380114B	BOLT 3/8 X 1 1/4
37	1	MS380200B	BOLT 3/8 X 2
38	1	MS380212B	BOLT 3/8 X 2 1/2
39	3	SM0000001	PIN ROLL 1/4 DIA X 1 3/8
40	3	M380WASHR	WASHER FLAT 3/8 ZINC
41	4	M580WASHR	WASHER FLAT 5/8
43	1	APALW3LPL	Alum Winch 3000 Left Side

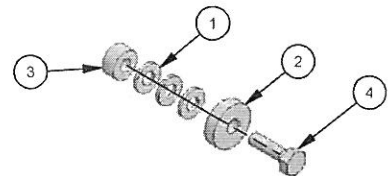

WHEEL KIT ALUM WINCH PARTS LIST			
ITEM	QTY	PART NUMBER	DESCRIPTION
1	3	S516WASHR	WASHER FLAT 5/16
2	1	BTDWASHER	WASHER FLAT ALUMINUM 1 1/8
3	1	WKITSPACR	SPACER
4	1	SN516100B	BOLT 5/16 X 1 NYLOC

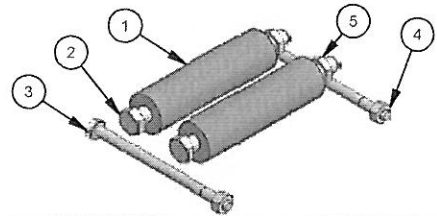

CABLE GUIDE ROLLER BOLT BAG LIST			
ITEM	QTY	PART NUMBER	DESCRIPTION
1	2	NYLTRN350	CABLE GUIDE ROLLER
2	2	MS380412B	BOLT 3/8 X 4 1/2
3	2	MS140400B	BOLT 1/4 X 4
4	2	S14LOCNUT	NUT 1/4 NYLOC
5	2	S38NYLJAM	NUT JAM 3/8 NYLOC BRASS

**NOTE**

\*24\* VERTICAL - SM0700024 - WINCH TT 2101-1 OILITE BRAKE PAD  
 \*24\* CANTILEVER - SM0700023 - WINCH 2.0625OD BRAKE PAD SMALL

# PARTS LIST

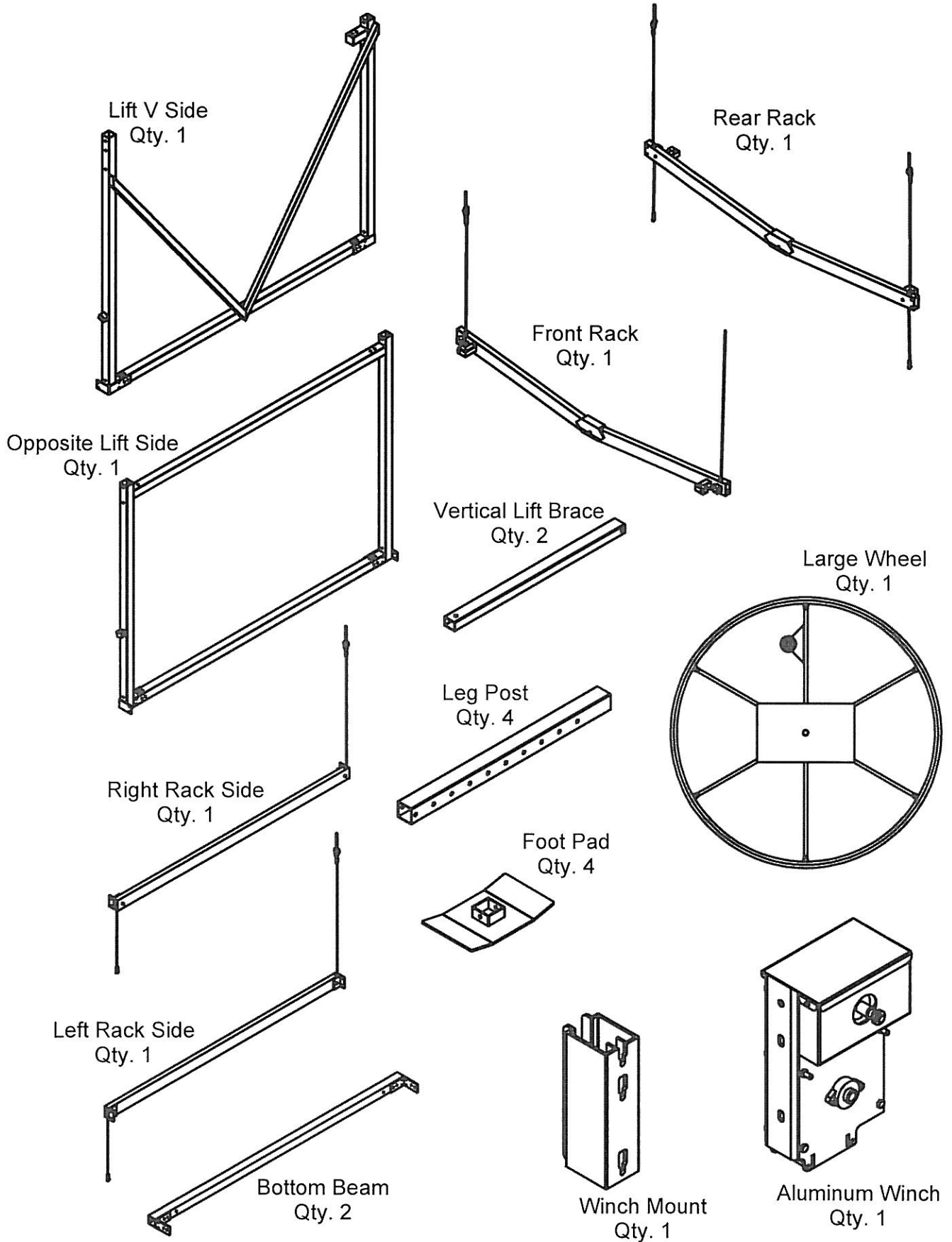

# FASTENERS AND HARDWARE

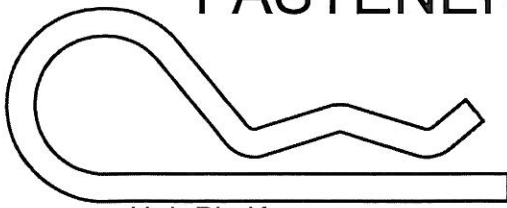

Hair Pin Keeper  
Qty. 4

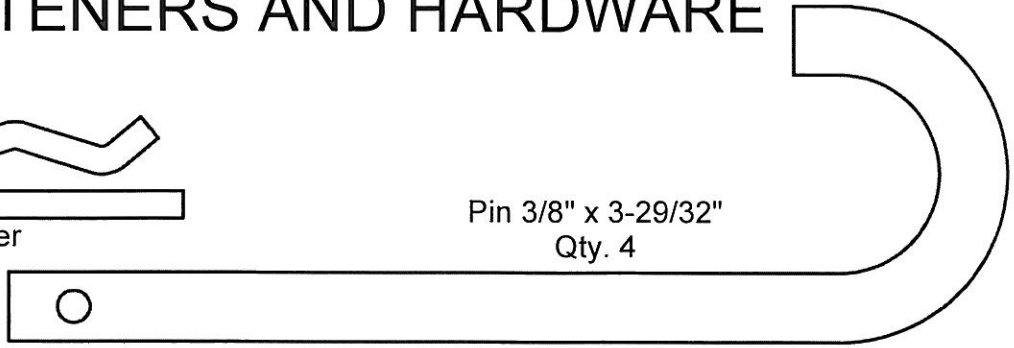

Pin 3/8" x 3-29/32"  
Qty. 4

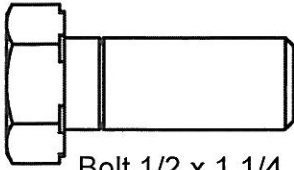

Bolt 1/2 x 1 1/4  
Qty. 2

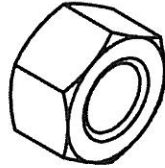

Nut 1/2 Nyloc Brass  
Qty. 5

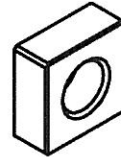

Nut Square 1/2  
Qty. 2

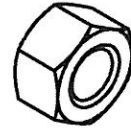

Nut 3/8 Brass  
Qty. 43

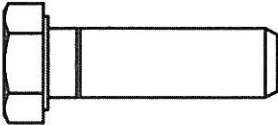

Bolt 3/8 x 1 1/4  
Qty. Eight



Washes Flat 3/8  
Qty. 72

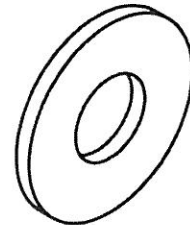

Washer Flat 1/2  
Qty. 7

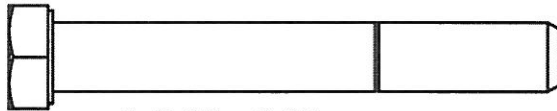

Bolt 3/8 x 2 3/4  
Qty. 5

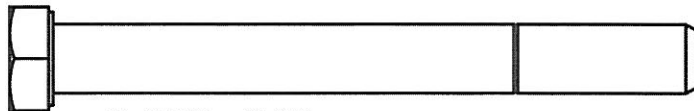

Bolt 3/8 x 3 1/2  
Qty. 4

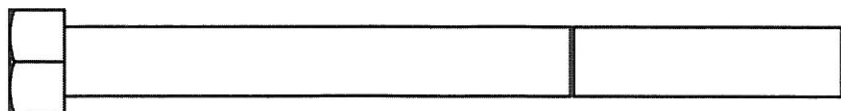

Bolt 3/8 x 3 3/4  
Qty. 2

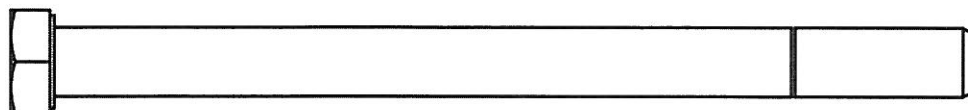

Bolt 3/8 x 4 1/4  
Qty. 24

# FASTENERS AND HARDWARE

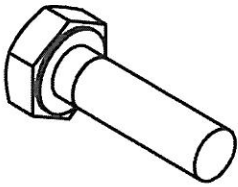

Bolt 5/16 X 1 Nyloc  
Qty. 1

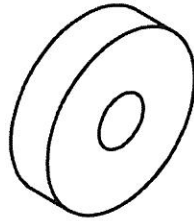

Washer Flat  
Aluminum 1 1/8  
Qty. 1



Washer Flat 5/16  
Qty. 3

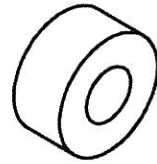

Spacer  
Qty. 1

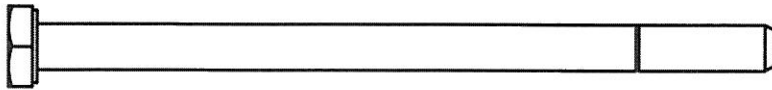

Bolt 1/4 x 4  
Qty. 2

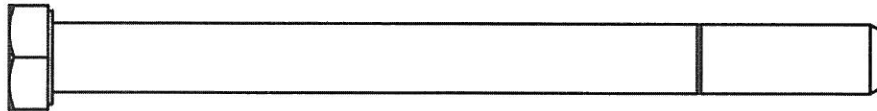

Bolt 3/8 x 4 1/2  
Qty. 2

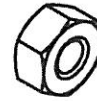

Nut 1/4 Nyloc  
Qty. 2

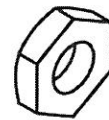

Nut Jam 3/8 Nyloc Brass  
Qty. 2

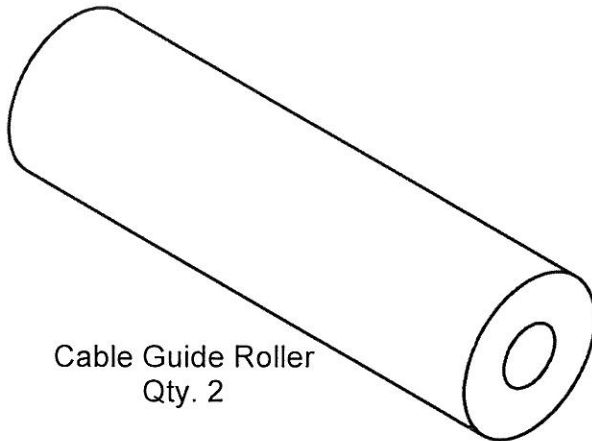

Cable Guide Roller  
Qty. 2

# ASSEMBLY INSTRUCTIONS

Your safety is the most important issue related to this product.

- Fully read and understand each step before proceeding with that step.
- Wear protective gloves, clothing and eyewear when assembling and installing the lift.
- Do not assemble, install or use this product if items are missing or damaged.

For ease of assembly find a flat area with plenty of room to assemble lift. The following tools will be needed for assembling lift:

1. Pair of 7/16" Wrenches
2. Pair of 9/16" Wrenches
3. 3/4" Wrench
4. Measuring Tape
5. Hammer
6. 3/16" Allen Wrench

Only hand tighten bolts and nuts until lift is completely assembled. (see Step 8)

## STEP 1

Slide Blue Caps on uprights as shown. Insert all four Leg Posts into Foot Pads, secure using one Bolt 3/8 x 3 1/2 and one Nut 3/8 Brass each place. Insert Leg Posts into Lift V-side and Opposite Lift Side as shown. Use one Pin 3/8 x 3 29/32 and Hair Pin Keeper for each Leg Post. No washers are used at this time.

**Note:** Do not place Blue Cap on the longest upright of the Lift V-Side.

